

Life Time Fitness
Conditions for All-Alcoholic Beverage License
Approved: July 16, 2018

These conditions will be in addition to the Board of Selectmen's Rules and Regulations for the Licensing and Sale of Alcoholic Beverages (Rules and Regulations). These conditions are in place to address the fact that the proposed Café and Pool Deck, as depicted on the License Plan and which will function as full-service restaurant spaces under the Rules and Regulations, are amenities located within the larger Life Time Fitness facility (LTF Facility).

A. General Conditions

- 1) Adequate physical and/or clear delineation must be provided between areas where alcohol may be served under this License and the other areas of the LTF Facility where alcohol may not be served, as approved by the Town in advance of alcohol service, as noted on the License Plan regarding the Café and the Pool Deck.
- 2) The menu general categories and general offerings within those categories shall at all times be substantially similar to those shown on the Menus provided with the application for this License.
- 3) There shall at all times be adequate staffing within the LTF Facility in accordance with customary standards and best practices for the service of alcohol, in order to implement and enforce these Conditions and the Rules and Regulations. If staffing levels fall below the preceding requirement, the number of patrons who may be served alcohol, and the areas within which said patrons may be served, shall be delimited by physical barriers / delineations, as the case may be, to maintain the required adequate staffing set forth in this General Condition. If such physical barriers / delineations are required hereunder, they shall conform to the provisions of General Condition 1 in that regard.
- 4) When alcohol service to patrons is not permitted under this License, all alcohol shall be stored in a secured manner to prevent unauthorized access.
- 5) The LTF Facility general manager and/or an assistant general manager(s) will be on duty at all times while alcohol is available to patrons. Additionally, whenever alcohol is available to patrons, a staff member regularly will observe areas where alcohol is available to patrons with the specific assignment of enforcing compliance with these Conditions, the Rules and Regulations, and all other applicable alcohol laws and regulations. This staff member may engage in other work assignments, but such other assignments shall not detract from the described primary compliance enforcement duties. The Town may require additional, more specific details regarding the staff compliance position.
- 6) Alcohol permitted to be served under these Conditions may only be consumed in the area in which it was ordered and served. That is, alcohol ordered and served in the Café must be consumed only within the Café and not transported in any manner to any other area of the LTF Facility; and alcohol ordered and served in the Pool Deck must be consumed only within the Pool Deck and not transported in any manner to any other area of the LTF Facility.

- 7) The Applicant shall provide to all its members, either within its customary membership documentation, or in a separate document, a requirement that members and their guests engage in responsible consumption of alcohol.
- 8) These General Conditions, and the Rules and Regulations, shall apply to any private event held at the LTF Facility, which private events shall be exclusively by invitation only and sponsored by or fully managed and provisioned by Life Time Fitness.
- 9) If these Conditions, in the Town's reasonable opinion, need review and potential revisions to ensure the LTF Facility continues to operate in accordance with customary standards and best practices for the service of alcohol, Life Time Fitness shall cooperate with the Town to make reasonable revisions to these Conditions for the purpose of ensuring that the LTF Facility operates in accordance with customary standards and best practices for the service of alcohol pursuant to the Rules and Regulations, and all other applicable alcohol laws and regulations.

B. Café Conditions. In addition to the General Conditions, the following shall also apply to the Café.

- 1) The Café portion of the LTF Facility, as shown on the License Plan, will operate as a full-service restaurant serving food and drink to patrons seated in a dining area, with service being provided to the patrons by wait staff. Take-out and counter orders may be permitted as an incidental and subordinate percentage of the food and beverage service, but no alcoholic beverages may be ordered at the Café kitchen counter in any case. Patrons consuming alcohol will be required to provide proper identification when ordering, and wait staff may require patrons to provide proper identification at the time the alcoholic beverage is delivered, as necessary, all as customary for the operation of a full-service restaurant.

C. Pool Deck Conditions. In addition to the General Conditions, the following shall also apply to the Pool Deck.

- 1) The outdoor seasonal portion of the licensed premises, the Pool Deck, as shown on the License Plan, will operate as a full-service restaurant serving food and drink to seated patrons, with service being provided to the patrons by wait staff. Each table where alcohol is being served shall be identified by a marker that is distinctive and easily recognized by staff and law enforcement officers. All alcohol sold shall be only in cups that are distinctive and easily recognizable by staff and law enforcement officers. Take-out and counter orders may be permitted as an incidental and subordinate percentage of the food and beverage service, but no alcoholic beverages may be ordered at the Bistro Kitchen counter in any case. Patrons consuming alcohol will be required to provide proper identification when ordering, and wait staff may require patrons to provide proper identification at the time the alcoholic beverage is delivered, as necessary, all as is customary for the operation of a full-service restaurant. In addition to any other staffing levels required under these Conditions and the Rules and Regulations, there will be adequate Pool Deck staff to assist with table busing, such that any seats or tables unattended even for a minimal period will be assumed vacant and cleaned for use by other patrons. During the seasons the Pool Deck is open for patrons, service of alcohol within the Pool Deck shall end 30 minutes after sundown, except for private events not open to

the general membership or the general public; provided that alcohol shall not be served at any such private event unless the Café/Bistro Kitchen (i) is open for business as permitted under these Special Conditions and the Rules and Regulations, (ii) is providing full restaurant service and (iii) such Café/Bistro Kitchen full restaurant service is available to the attendees of such private events.

ATTACHMENTS

A License Plan

ATTACHMENT A

License Plan

[page blank – see following]

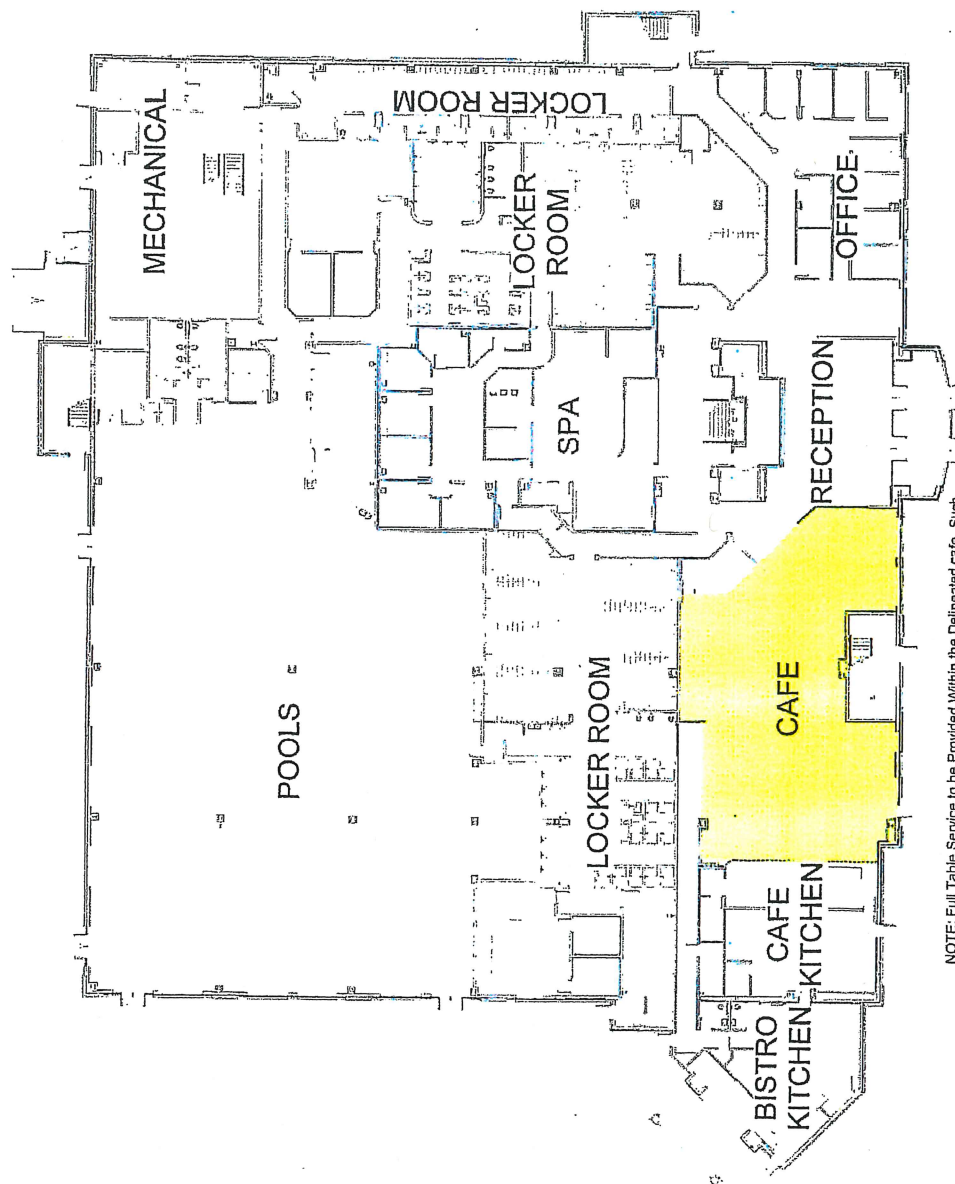

NOTE: Full Table Service to be Provided Within the Delineated cafe, Such Delineation Method to be Approved by the Town Prior to Alcohol Service

Cafe Seating:
Total: 151

Cafe Square Footage: 3,315

